

# INSTALLATION GUIDE - WITH TRANSFORMER & PHOTO ELECTRIC CONTROL

Contact your electrical inspector to see what the local code requirements are for the electrification of a gas lamp.

1. Make sure that the gas supply to the lamp has been disconnected and permanently sealed by your gas company.
2. Remove the lamphood from the post by removing the screw located at the base of the lamphood.
3. Remove the gas valve and mantle holder support assembly from the lamp frame.
4. Insert REALITE fixture and firmly secure as shown in diagram.
5. Drill a 7/8 inch hole about 4 inches below the top of the lamp post. Do not point the photo control directly towards a strong nighttime light source including passing car headlights.
6. Bury the 14/2 UF to the depth required by local codes. Usually this is 6 inches. Use only cable rated by UL for direct underground burial or enclose the cable in a watertight conduit. 18 gauge through 14 gauge wire with or without ground may be used. (18 gauge cable should not be used if the distance exceeds 100 feet.) Cable that is not rated by UL for direct underground burial, voids warranty.
7. Connect the cable to the terminals, plug in and secure the transformer.
8. Use only #1156 automotive back up lamps in this unit. The transformer and photo control are designed to operate only one REALITE fixture. Failure to use the correct lamps or lighting more than one fixture with this kit will destroy the transformer.
9. After power has been turned on, covering the photo electric eye with your hand will light the lamps.

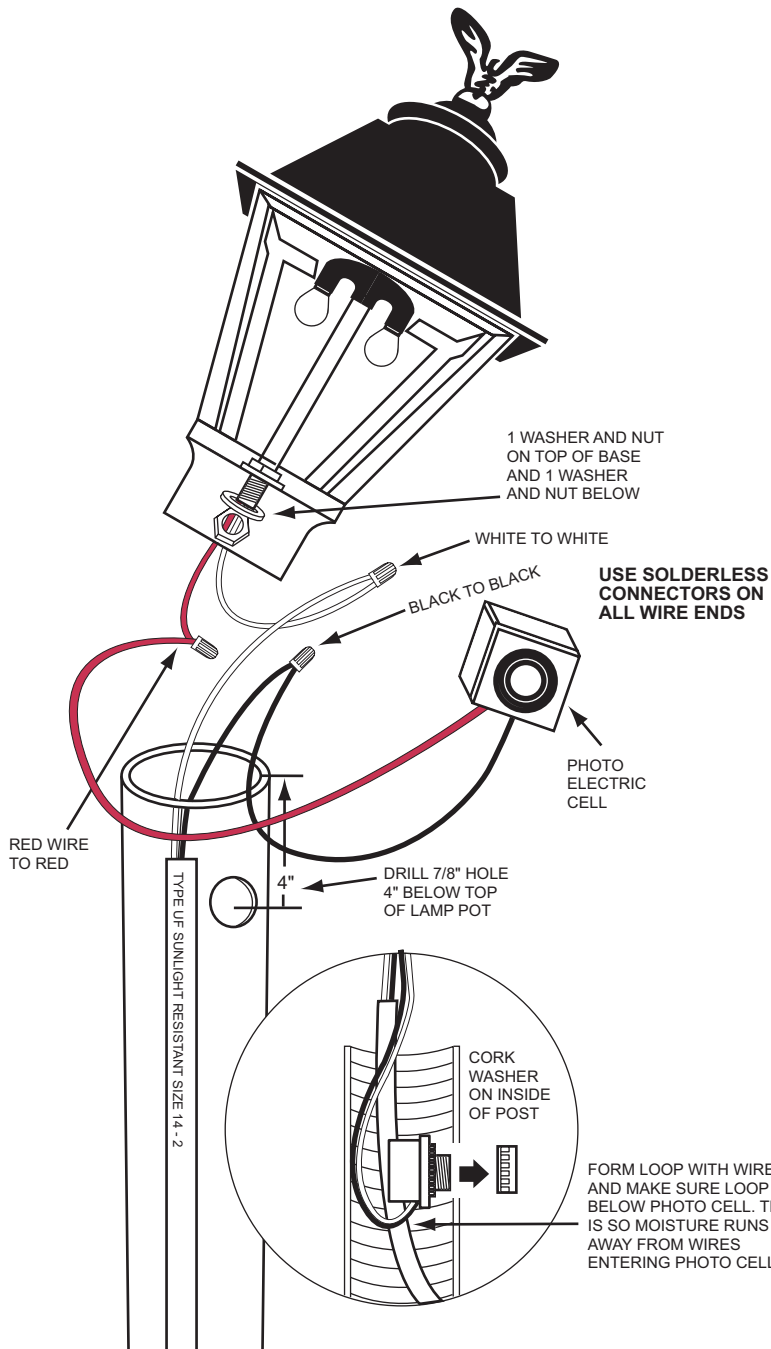
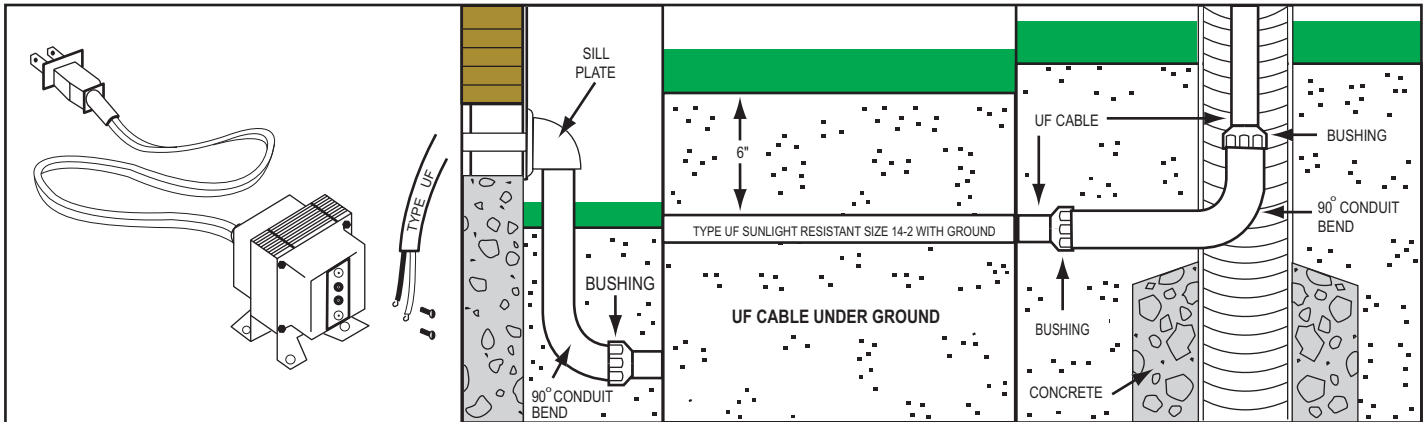

To get optimum bulb life in your Low Voltage Conversion Kit we recommend the following:

The bulbs are in series, therefore when one bulb burns out neither bulb will light. Replace both bulbs with new ones, saving the one used bulb that is still good. (The burned out bulb usually appears gray or blackened.) the next time a bulb burns out replace the bad bulb with the good used bulb that you saved. Using bulbs of the same age will give you efficient bulb usage.

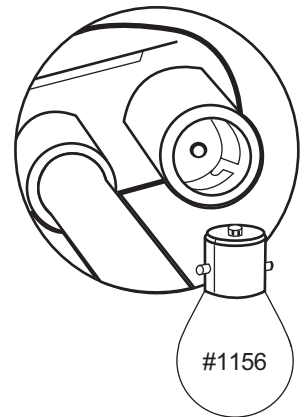

**WARRANTY**

Gaslight Conversions, Inc. warrants that your conversion kit, excluding bulbs, to be free of defect for one year from the date of purchase. If your conversion kit becomes defective within one year of the date of purchase, return the kit postage prepaid for prompt replacement. Include your mailing address and dated proof of purchase. Send to: Gaslight Conversions, Inc., 1039 Charles Ave., St. Paul, MN 55104.

Warranty is void if the defect is due to damage, product alteration, connection to an improper electrical supply, installation that is not in compliance with all national and local electrical codes, or where the product is not used in accordance with owner instructions. In no event shall Gaslight Conversions, Inc. be responsible for incidental or consequential damages.